

Installing the equipment

Wall Mounting the Compact Selector

The Compact Selector can be wall mounted using the screws supplied. When fitting to masonry use the two wall plugs supplied. (Drill size 6mm).

1. Mark the wall using the template supplied and then fix in the screws so that approximately 6mm is protruding from the wall.
2. Locate the screws in the slots in the Selector & slide down onto the screws.

Note: The mains supply cable entry can be from the top or the bottom of the Selector. By removing the stick on feet on the base and undoing the four screws, the base can be rotated.

Connecting the Compact Selector to a Video recorder

There is a relay contact "video trigger" output available, by using the RJ45 connector socket on the top of the selector. The contact momentarily closes whenever a "search" is selected, this can be used as an input trigger to start recording on a DVR (Digital Video Recorder).

To use the RJ45 connector socket, first remove the protective film that covers it. To connect to the socket use an RJ45 plug, relay connections are between pins 7-8. (Contact rating: IA@24VDC). Suitable break out cable Farnell no. 106-332

Connections on the RJ45 connector

1. Common connection (+12volts)
2. Push-button switch input (-ve)
3. Push-button switch lamp (-ve)
4. Green lamp (-ve)
5. Red lamp (-ve)
6. Sounder (-ve)
7. * Video Trigger Relay contact (Normally open)
8. * Video Trigger Relay contact (Normally open)

for further information or advice on using your Random Search Selector, or for details of associated products such as scanners, metal detectors, etc. please contact;

Insight Security

Unit 2, Cliffe Industrial Estate, Lewes, East Sussex, BN8 6JL

tel: 01273 475500 www.insight-security.com

01EFSZ000

Random Search Selector - User Guide

How the Random Selector works

The Random Search Selector is designed to eliminate the risk of search personnel being accused of favouritism or prejudice, when selecting which persons passing through the control point are to be searched and which are to be allowed to pass without search.

All persons passing through the control point will press the push button as they pass. A red indicator light accompanied by a high tone indicates that the person is to be searched. A green indicator light, accompanied by a low tone, indicates a pass. The overall percentage of personnel to be selected can be varied from 0%-100%. The selection is random, the odds of being selected are the same every time the button is pressed.

The Compact Selector has built in counters to show the number of searches and passes. The setting of the percentage to be searched and the resetting of the search and pass counters operate under key supervision allowing full control of the system.

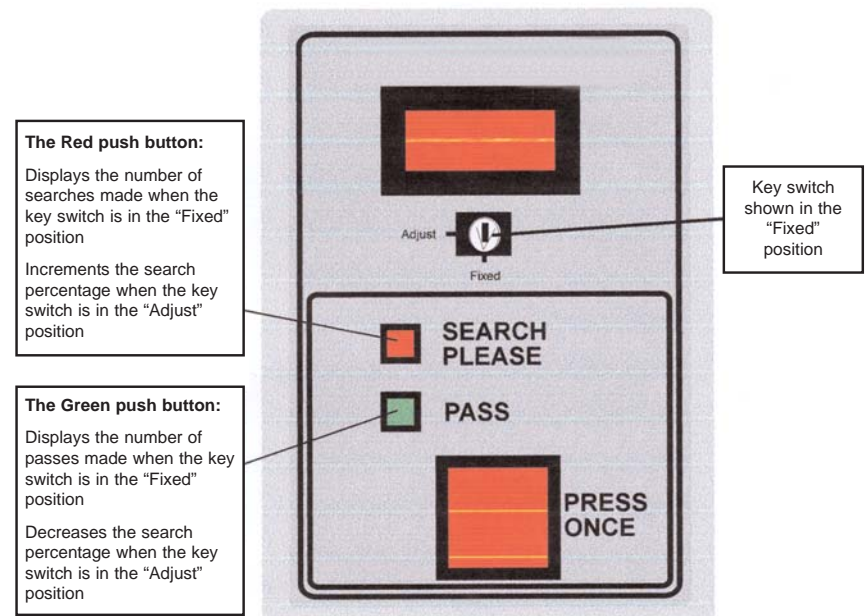

Adjusting the Search Rate percentage setting;

The default search setting for the Selector is 50%. This setting is restored each time the unit is connected to the mains power. For many applications this setting will be ideal, but if you need to set a different search rate, it is a simple task that takes just a few seconds;

- 1) Adjusting the percentage.
 - a) Turn the key switch to the ADJUST position.
 - b) Press the red or green push buttons to increase or decrease the percentage setting.
 - c) The new setting can be locked in by turning the key switch back to the fixed position.
- 2) Using the built in counters.
 - a) Turn the key switch to the FIXED position.
 - b) Press the green push button - the number of passes will be displayed.
 - c) Press the red push button - the number of searches will be displayed.
- 3) Re-setting the built-in counters.
 - a) Make sure the key switch is set to the FIXED position
 - b) Press the red and green push buttons together and wait until the display has cleared. Then turn the key switch to the ADJUST position and back again to the FIXED position. Both counters should read zero.
- 4) Connecting the Compact Selector to power
Whenever the Selector is reconnected to a power supply it will run through a brief test and the percentage setting will default to 50%.

Please note: The Compact Selector is suitable for internal use / mounting only.

Optional Extra Products;



An optional Remote Pushbutton (supplied with 4.3 metre extension cable), is available to connect to the Selector:

prod code: [EP SS2000RB](#)



An optional Remote Indicator (supplied with 4.3 metre extension cable), is available to connect to the Selector:

prod code: [EP SS2000RI](#)

A Quick Guide to Operating a Random Search Scheme

The random search selector is what it says, random!

It is impossible to predict the outcome of an activation, regardless of the setting (except when the selector setting is set to 0% or 100%).

Note: on power up the search setting of the selector defaults to 50%.

In order to maintain a customised setting once adjusted, it is recommended that the selector is wired to a permanent power supply.

50% of what?

The setting represents the odds of selection, e.g. at 20% there is a one in five chance of getting a red indication (i.e. indicating that the person has been selected to be searched). If you want to see how it works, set your unit on 20% and press the button a large number of times, then look at the values of the search and pass counts, the ratio will be almost 4 to 1, not exactly but that's random for you!

What is the right setting for the selector?

The principle behind operating a random search is to deter, so the security checks made on those who are selected must be thorough. It is important that the setting of the selector is appropriate for your application. If there are 100 people passing through the control point in the space of five minutes and in that time it is only possible to check ten, the maximum percentage setting for the selector should be ten per cent.

How can you tell if the random search is working?

If the 10% checked are clear, then the chances are so are the other 90%. Every minute, every day of the year the Random Search Scheme can be operated.

Suggestions / options to make your Search Scheme more effective:

- Advertise the searching at all entry points, make a clear statement of policy, i.e. "Deterrence not Detection".
- The selector can be used to trigger a video recording system which not only oversees the selection procedure, but will also ensure that the checks are conducted correctly at all times. This type of installation can be advantageous on sites operating 24 hours a day.